

- 更经济 MORE ECONOMICAL
- 更安全 MORE SAFE
- 更高效 MORE EFFICIENT
- 更环保 MORE ENVIRONMENTALLY FRIENDLY

中国桥梁施工系统服务商  
CHINA BRIDGE CONSTRUCTION SYSTEM SERVICE



咨询热线 | 400-0000-661  
Advisory hotline

地址: 浙江省嘉兴市秀洲区新城街道成秀路251号 | 电话: 0573-83972615 | 邮箱: zjxtql@126.com | 网址: www.zjxtql.com  
Add: 251 Chengxiu Road, Xincheng street, Xiuzhou District, Jiaxing City, Zhejiang, China. | Tel: 0573-83972615 | Email: zjxtql@126.com | Web: www.zjxtql.com

产品图片仅供参考, 请以实物为准 202309

临时安全护栏  
Temporary Safety Barrier

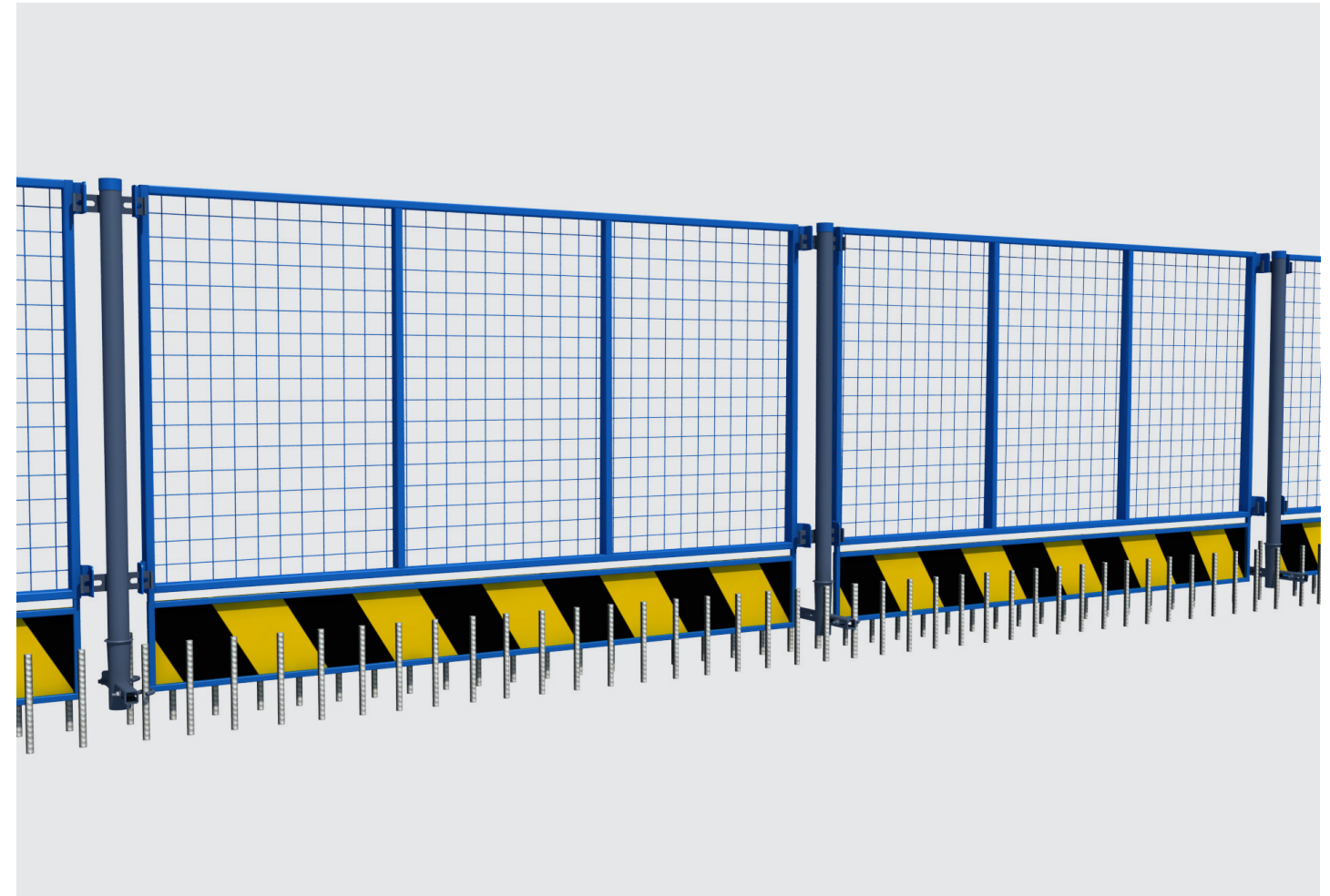

## 桥梁施工临边安全解决方案

SAFETY SOLUTIONS FOR BRIDGE CONSTRUCTION

### 设计理念

DESIGN CONCEPT

桥梁施工现场的临边防护, 是保证施工人员人身安全的重要防护设施。传统临边防护的立柱多采用钢管或钢筋, 防护网多采用塑料密目网, 底座多采用焊接方式固定或直接放置等方式, 此种防护方法无法满足规范要求的安全防护标准。且安装不方便, 外观形象差, 无法达到施工现场安全文明生产的要求。针对以上问题, 兴土股份研发中心经过细心调研、合力攻关, 研发出的通用型桥梁施工临时安全护栏, 彻底解决各种施工环境下的临边安全防护问题。

The edge protection of bridge construction site is an important protection facility to ensure the personal safety of construction personnel. Steel pipe or steel bar are usually used for the column of traditional edge protection, plastic dense mesh is often used for the protective mesh, and welding or direct placement is often used for the base, which can not meet the safety protection standard required by the code. Moreover, the installation is not convenient and the appearance image is poor, which can not meet the requirements of safe and civilized production on the construction site. In view of the above problems, Xingtuo bridge R & D center, after careful investigation and joint efforts to tackle key problems, has developed a general temporary safety barrier for bridge construction to completely solve the problems of edge safety protection in various construction environments.

### 方案优势

PROGRAM ADVANTAGE

**多功能性** 针对不同施工临边环境, 专门设计四种类型底座, 不但可以用于桥梁施工, 也适用于建筑施工现场的四口、五临边、安全通道等方面, 适用范围非常广泛。

**安全性** 抗水平推力经专业机构测试, 可达 1000 牛以上, 完全满足规范规定的临边防护要求, 能够有效对施工人员起到安全保护作用。

**周转使用** 产品装配式连接, 材料施工零损伤, 安装快捷并能够多次周转使用, 有效降低了施工成本。

"Multi function", specially designed four types of bases for different construction edge environment, not only can be used for bridge construction, but also for four entrances, five edges, safe passage and other aspects of the construction site, with a wide range of application.

"Safety", the horizontal thrust resistance can reach more than 1000 n after testing by professional organizations, which fully meets the requirements of the specification for edge protection, and can effectively play a role of safety protection for construction personnel.

"Turnover use", product assembly connection, zero damage in material construction, quick installation and multiple turnover use, effectively reducing the construction cost.

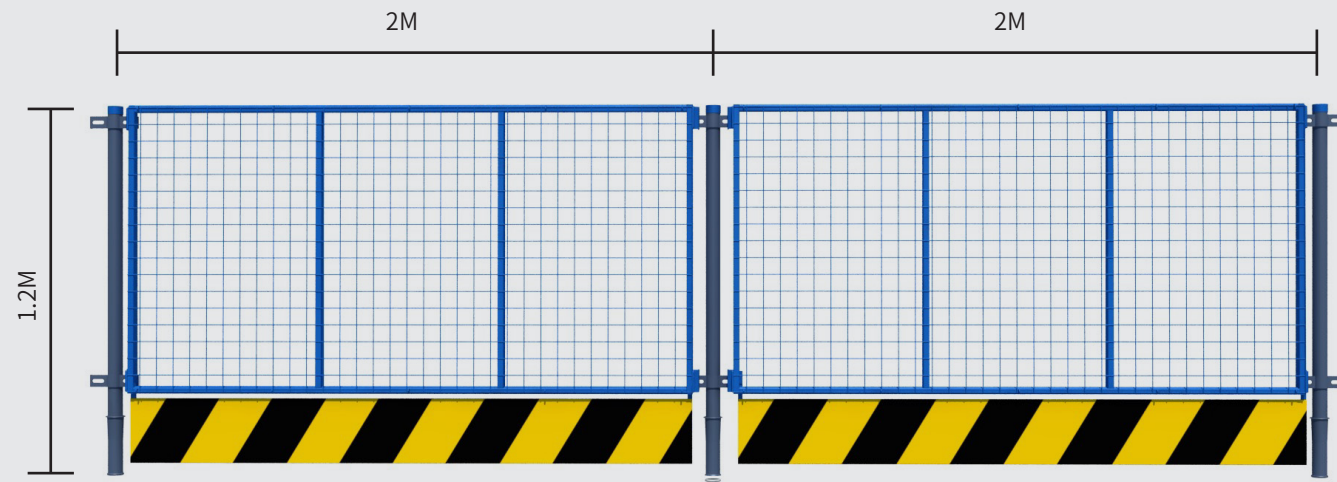

注:更多工程案例和参数信息,请扫描二维码。  
Note: If you want to learn more, please scan the QR code.



专用于土质环境施工

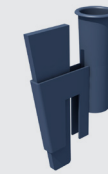

专用于围堰墙体位置



专用于钢结构类平台

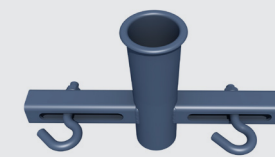

专用于防撞护栏位置



专用于防撞护栏位置



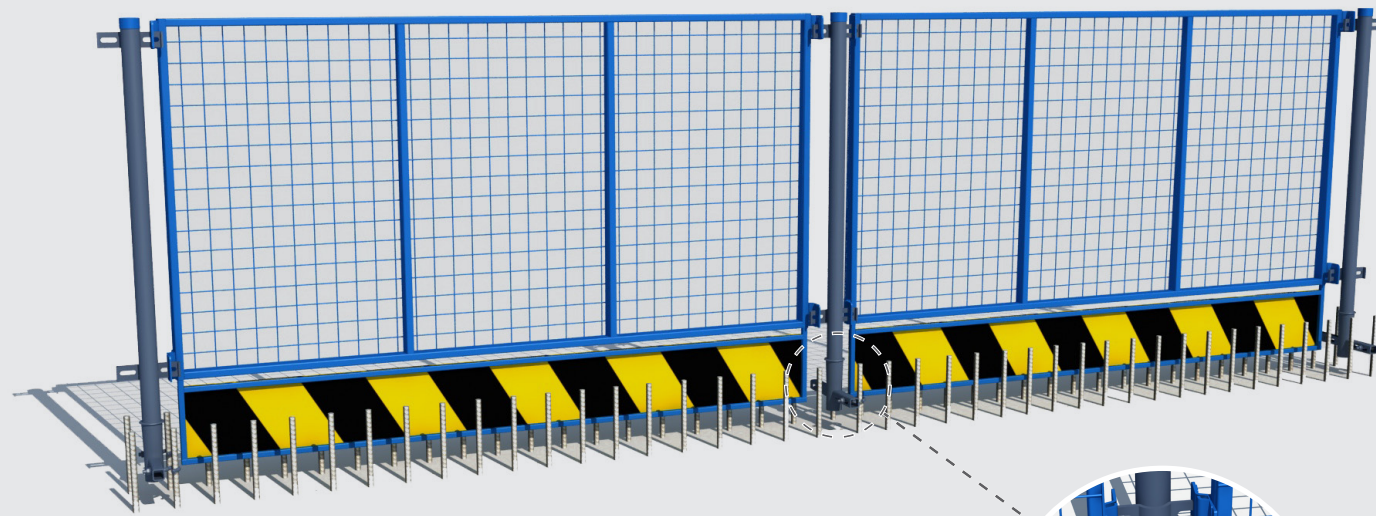

兴土股份专用于桥面防撞护栏位置的临时安全护栏,立柱与预埋钢筋连接处,采用弯钩式底座连接,安装效率高,且对预埋钢筋无损伤。护栏高1.2m,抗水平推力达1000N(1000牛),能有效对施工人员起到安全保护作用,完全满足规范规定的安全防护要求。

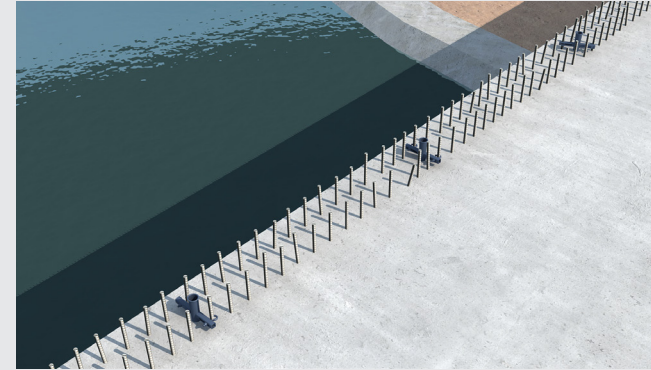
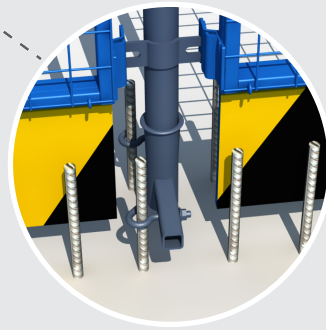

①底座安装

②立柱安装



③网片安装





兴土股份专用于桥面防撞护栏位置的临时安全护栏,为解决原弯钩式底座不能够遮挡预埋钢筋结构和放置踢脚板不便的问题,将底座钢管位置进行了调整,研发出了L型弯钩式底座。此种底座不仅能够完全遮挡预埋钢筋结构有效保障人员安全,而且安装踢脚板更加便捷。

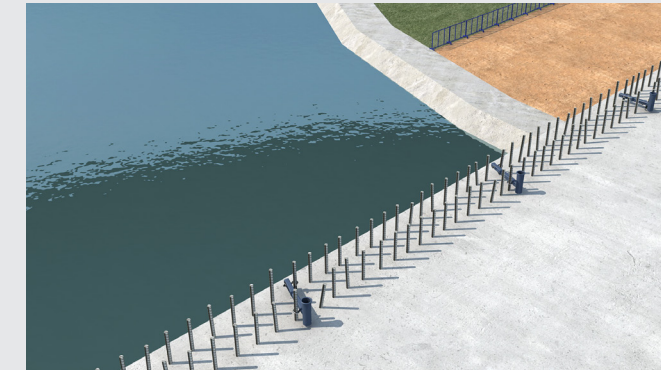

①底座安装

②立柱安装



③网片安装

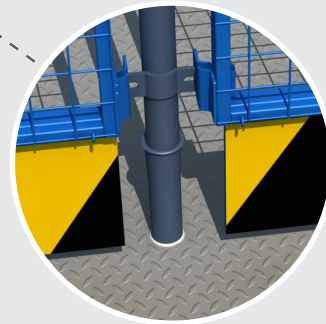

兴土股份专用于钢结构类施工位置的临时安全护栏,采用直筒式底座,将底座直接焊接在钢板地面上。底座安装完成后,将立柱插入底座套筒内,最后安装专用的防护网片及踢脚板。安拆便捷,整体安装只需一个工,2分钟即可完成护栏的安装或拆除。

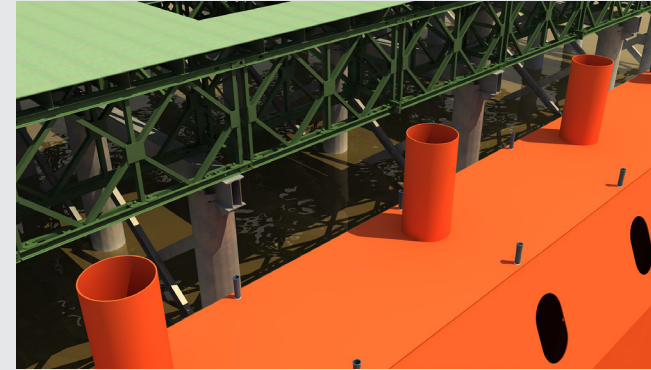

①底座安装



②立柱安装



③网片安装

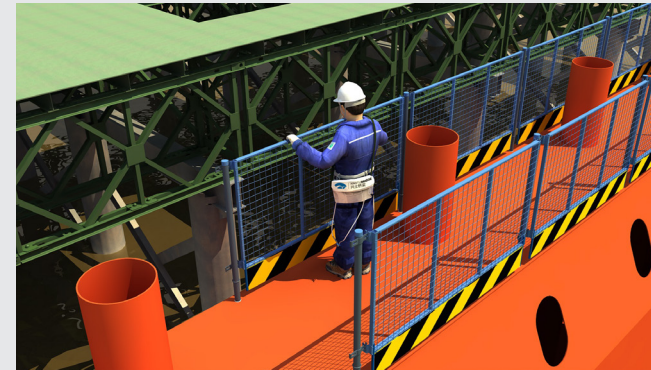



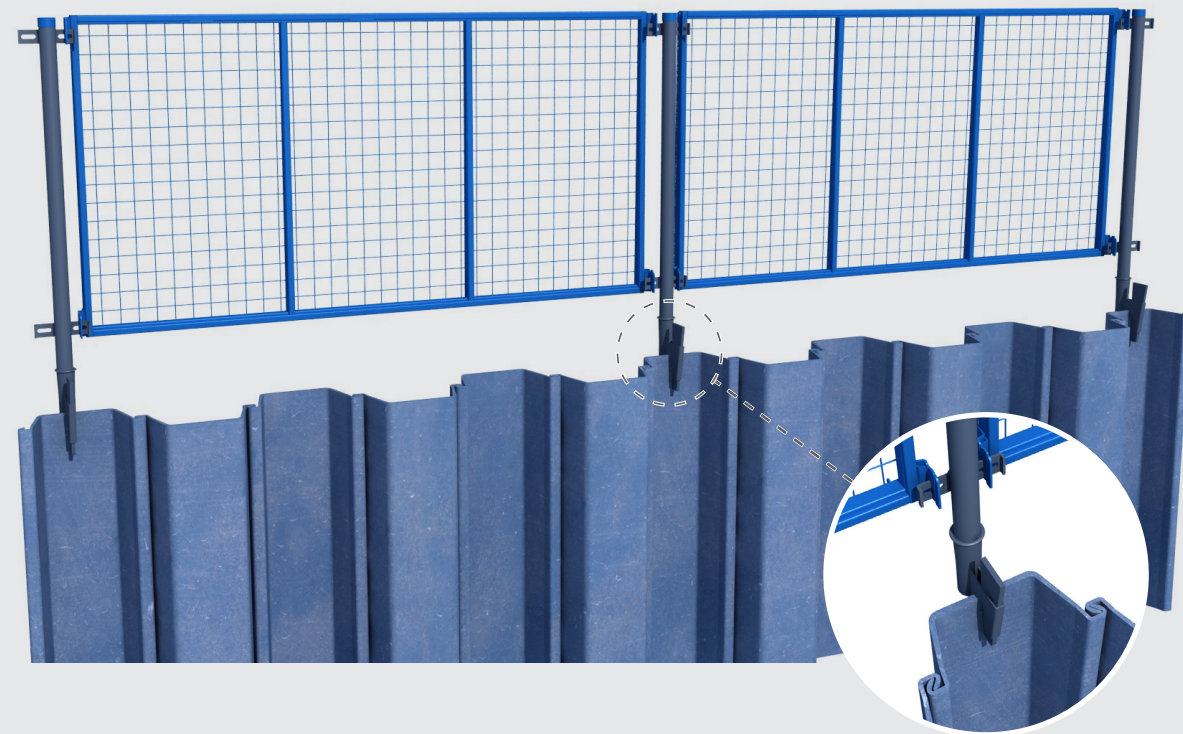

兴士股份专用于围堰壁体位置的临时安全护栏,采用板插式底座,将底座套在围堰壁体上,插入钢楔(敲紧),固定底座。适用于钢板桩、锁口钢管桩等钢围堰壁体,产品标准化的设计,可多次周转使用,有效提高资源的利用率。

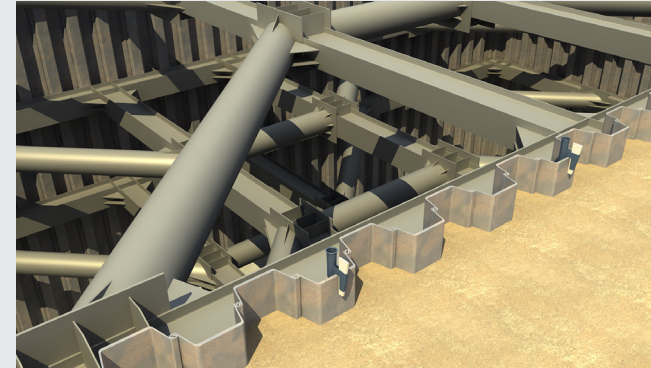

①底座安装



②立柱安装

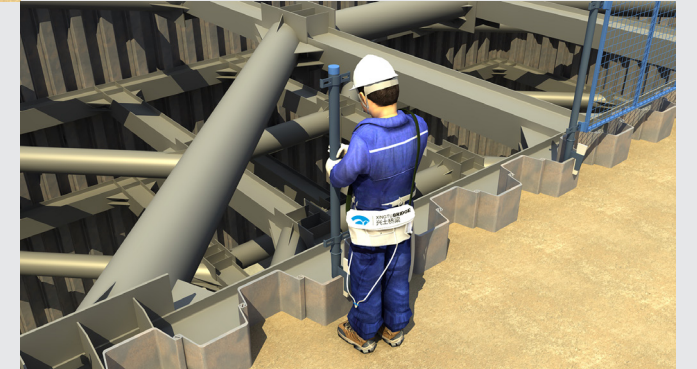

③网片安装





兴土股份专用于土质环境施工位置的临时安全护栏，区别于在基坑周围采用钢管打入土中的传统临时护栏，采用直插式底座，将底座直接插入土中固定。对于软质泥土可加装连接管，安装扣件螺母，使底座连成一体，保证软质泥土环境下防护栏的稳定。

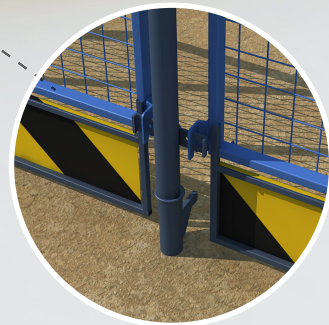

①底座安装



②立柱安装

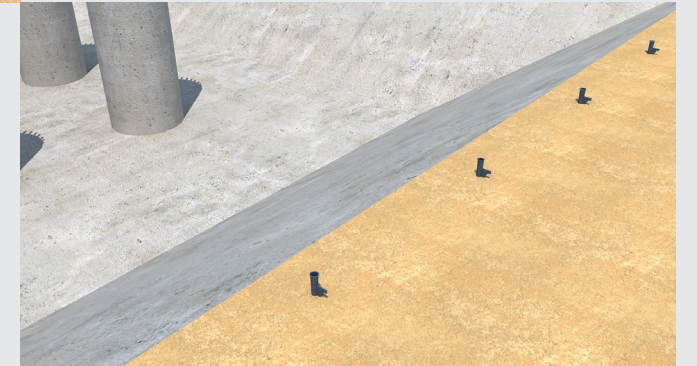



③网片安装

构件表-底座 | Component Table - Base

序号	名称	重量/kg	图样	规格	单位	材料
1	弯钩式底座30	1.24		30-282*200	个	Q235
2	L型弯钩式底座30	1.83		50*30-406*200	个	Q235
3	直筒式底座	0.78		φ48*200	个	Q235
4	板插式底座	1.09		φ48*200	个	Q235
5	直插式底座	2.93		φ48*600	个	Q235

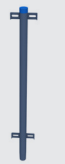
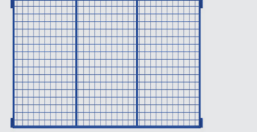
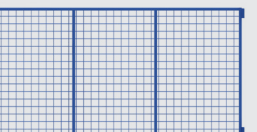
构件表-通用标准件 | Component Table - General Standard Parts

序号	名称	重量/kg	图样	规格	单位	材料
1	立柱	4.26		φ48*1100	根	Q235
2	1.5m防护网	10.74		1400*947	件	Q235
3	2m防护网	13.01		1900*947	件	Q235
4	踢脚板1.5m (选配)	3.93		1360*180*245	件	Q235
5	踢脚板2m (选配)	4.49		1860*180*245	件	Q235





中铁三局沪苏湖铁路1标项目二分部



嘉兴市市区快速路环线工程(一期)土建二标